90° Peel strength table P90-200N

Suitable for 90° Peel adhesion test



(P90-200N table set)



(P90-200N application)

Test stand, force gauge, film chucks are sold separately.

[Applications]

The 90° Peel strength table is installed on the Imada's force gauge and motorized test stand for peel adhesion test of various glueing.

[Feature]

This table keep the measurement angle as 90° by self adjusting sliding system.

[P90-200N Specifications]

Model	P90-200N		
Sample length(max)	155mm		
Sample width(max)	80mm		
Capacity	200N		
Dimension	See below dimension		
Weight	Approx. 3kg		
Recommended test stand	MX-2000N	MV-100AC/BA	
	MX-500N	MV500NII	(*1)
With force gauge	Digital force gauge DPZ, DPS series		(*2)

(*1) Motorized stand which can keep settled speed is more suitable for peel adhesion test.

(*2) We recommend digital force gauge for peel adhesion test. The stroke of mechanical force gauge is big so that it can not keep measurement angle 90°.

[Dimension]

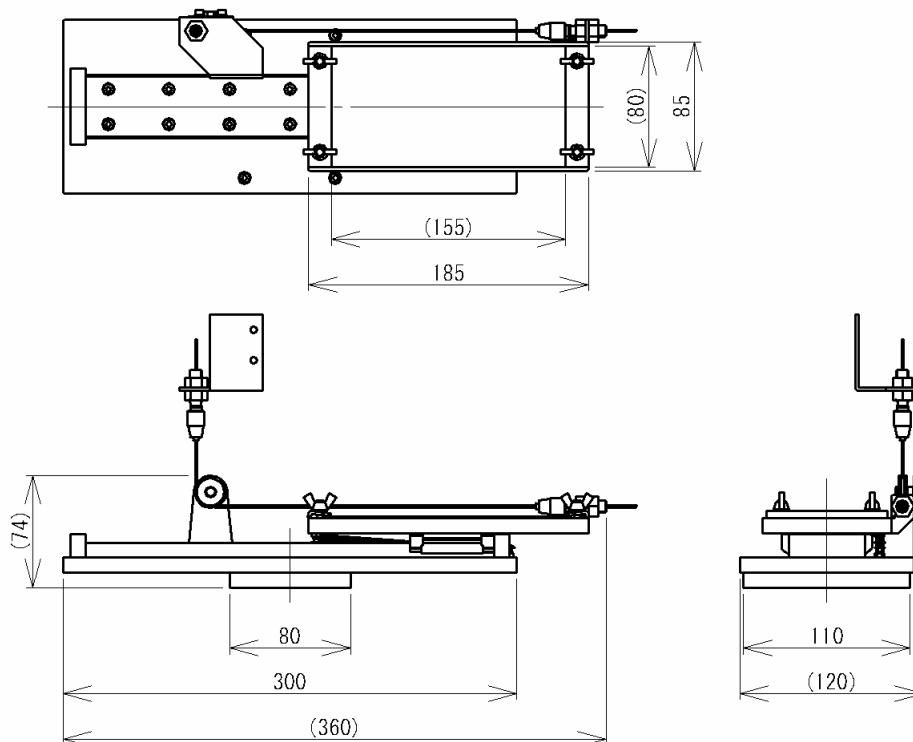

[Note]

-When you order only P90-200N, you will need additional processing on force gauge mounting plate.

-All information is subject to change without prior notice.